

## Where do they live?

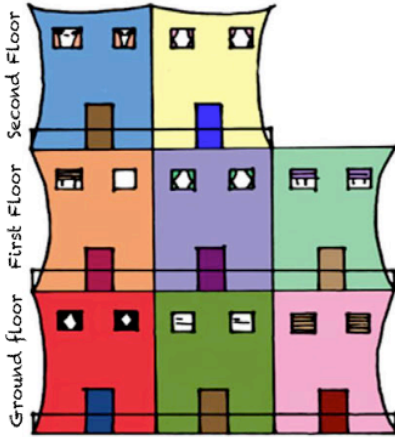

Aisha lives on the first floor.  
 Luca lives directly above Josh.  
 Roman lives next to Lisa.  
 Tina lives to the left of Josh and to the right of Betty.  
 Thomas lives to the left of Luca.  
 Lisa lives right above Thomas.

Where do they live?



## Where do they live?



Aisha lives on the first floor.  
 Luca lives directly above Josh.  
 Roman lives next to Lisa.  
 Tina lives to the left of Josh and to the right of Betty.  
 Thomas lives to the left of Luca.  
 Lisa lives right above Thomas.

Where do they live?

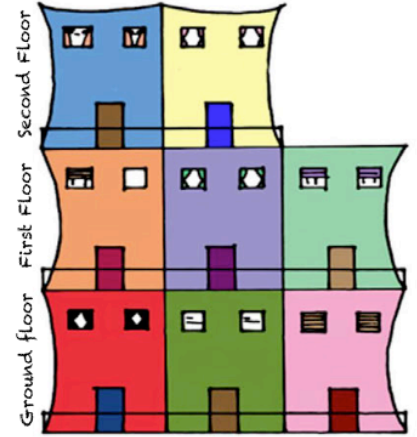

## Where do they live?



Aisha lives on the first floor.  
 Luca lives directly above Josh.  
 Roman lives next to Lisa.  
 Tina lives to the left of Josh and to the right of Betty.  
 Thomas lives to the left of Luca.  
 Lisa lives right above Thomas.

Where do they live?

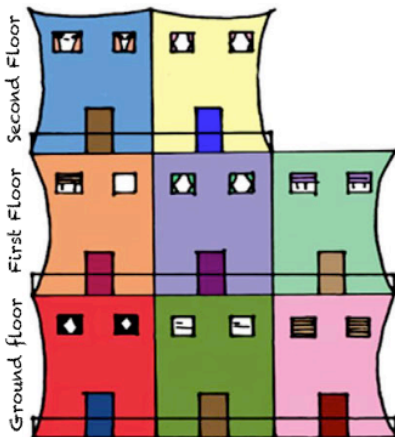

## Where do they live?



Aisha lives on the first floor.  
 Luca lives directly above Josh.  
 Roman lives next to Lisa.  
 Tina lives to the left of Josh and to the right of Betty.  
 Thomas lives to the left of Luca.  
 Lisa lives right above Thomas.

Where do they live?

